

FINITURE LAVABO / WASHBASIN FINISHES



Essential colors

- Bianco / white glossy
- Nero / black glossy
- Fumo - glossy
- Talpa - glossy

Le Terre di Cielo

- Talco
- Pomice
- Brina
- Basalto
- Lavagna
- Cemento
- Fango
- Cacao
- Arenaria
- Avena
- Lino
- Agave
- Muschio
- Polvere
- Cipria
- Canapa

Le Acque di Cielo

- Oltremare
- Smeraldo
- Alga
- Corallo
- Ninfea
- Anemone

FINITURE PIANO / COUNTERTOP FINISHES



Essential colors

- Bianco / white glossy
- Nero / black glossy
- Fumo - glossy
- Talpa - glossy

Le Terre di Cielo

- Talco
- Pomice
- Brina
- Basalto
- Lavagna
- Cemento
- Fango
- Cacao
- Arenaria
- Avena
- Lino
- Agave
- Muschio
- Polvere
- Cipria
- Canapa

Le Acque di Cielo

- Oltremare
- Smeraldo
- Alga
- Corallo
- Ninfea
- Anemone

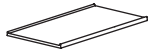

Marmi / marbles

- Bianco Carrara Gioia
- Nero Marquina

MOBILE MANIGLIA ORIZZONTALE E VERTICALE - MENSOLA / CABINET WITH HORIZONTAL AND VERTICAL HANDLE - SHELF

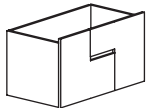

Essential colors

- Fumo - glossy
- Talpa - glossy

Le Terre di Cielo

- Talco
- Pomice
- Brina
- Basalto
- Cemento
- Arenaria
- Avena
- Muschio
- Agave

Le Acque di Cielo

- Oltremare
- Smeraldo
- Alga
- Corallo
- Ninfea
- Anemone

Essenze / wood essences

- Rovere Sbiancato
- Rovere Naturale
- Rovere Nero
- Rovere Tinto Noce
- Eucalipto

MOBILE CON FRONTALE A LISTELLI / CABINET WITH SLATTED FRONT

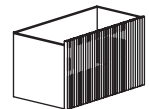

Essenze / wood essences

- Rovere Sbiancato
- Rovere Naturale
- Rovere Nero
- Rovere Tinto Noce
- Eucalipto

ACCESSORI / ACCESSORIES

Pilette / click-clack drains:

PIL01 - Piletta universale click-clack CROMO con coperchio in ceramica
Universal click-clack drain in CHROME with ceramic lid

PIL01NM - Piletta universale click-clack NERO MATT con coperchio in ceramica
Universal click-clack drain in MATT BLACK with ceramic lid

PIL01BR - Piletta universale click-clack BRONZO con coperchio in ceramica
Universal click-clack drain in BRONZE with ceramic lid

PIL01CM - Piletta universale click-clack CEMENTO con coperchio in ceramica
Universal click-clack drain in CEMENTO with ceramic lid

Sifoni / siphons:

SISP - Sifone CROMO
CHROME siphon

SIFN - Sifone NERO MATT
MATT BLACK siphon

SIFBR - Sifone BRONZO
BRONZE siphon

SIFCM - Sifone CEMENTO
CEMENTO siphon

Filo

lavabo sottopiano con piano e mobile 90 maniglia orizzontale/verticale - lavabo a sinistra

Undercounter washbasin with countertop and cabinet 90, horizontal/vertical handle - washbasin on the left side

cielo
handmade in Italy

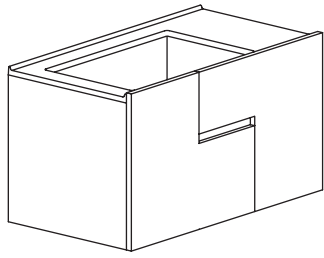

lavabo / washbasin
art. FILASPR58

top / countertop
art. FIP90SX / FIP90MSX

mobile maniglia orizzontale
/ horizontal handle cabinet
art. FIC90LO / FIC90EO

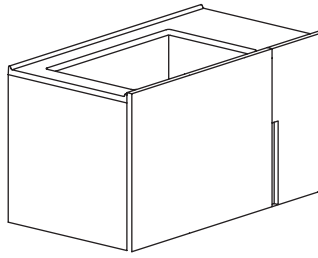

lavabo / washbasin
art. FILASPR58

top / countertop
art. FIP90SX / FIP90MSX

mobile maniglia verticale
/ vertical handle cabinet
art. FIC90LV / FIC90EV

NOTE/NOTES

Disponibile nell'opzione senza foro rubinetto (piano art. FIP90SXSF / FIP90MSXSF)
Available the option without tap hole (countertop art. FIP90SXSF / FIP90MSXSF)

Settembre 2024

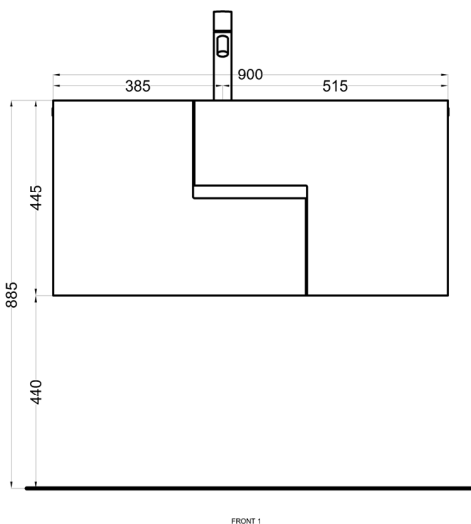
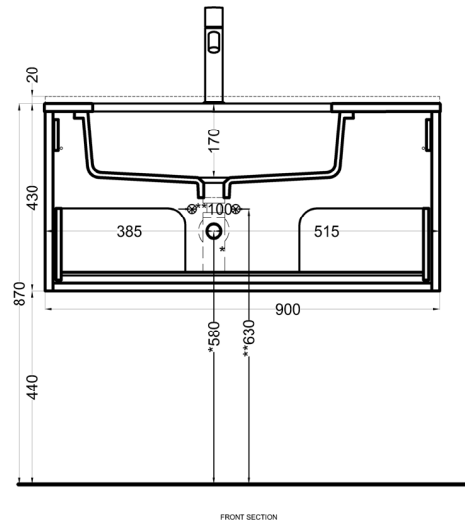
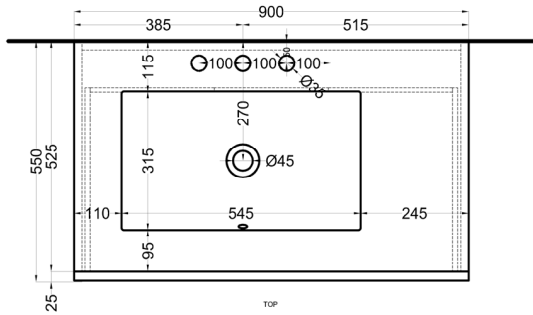

FRONT 1

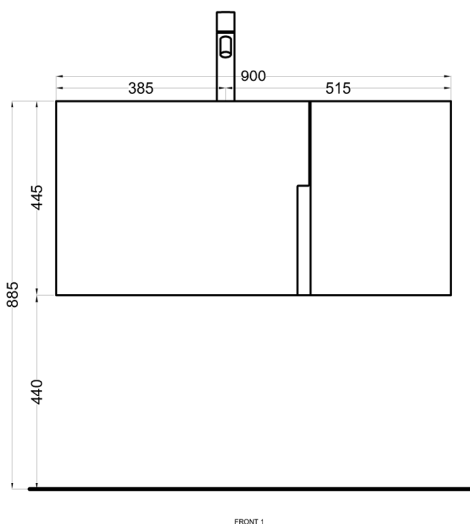

FRONT 1

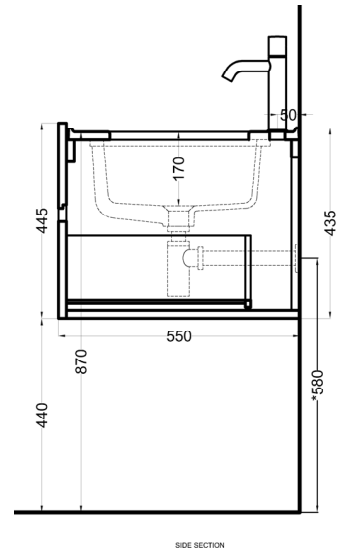

SIDE SECTION

* = water outlet (with standard siphon)
** = water inlet (hot/cold)
° = fixings

ATTENZIONE:

Superfici, pesi e misure riportate possono presentare leggere differenze rispetto ai pezzi reali, in considerazione e accordo delle caratteristiche di tolleranza intrinseche del materiale ceramico e del suo processo produttivo. L'azienda si riserva di cambiare schede tecniche e caratteristiche di funzionamento degli articoli in ogni momento e senza necessità di preavviso.

ATTENTION:

Surfaces, weights and dimensions can show some little differences compared to the real item, following typical intrinsic characteristics of ceramics material and production. The company reserves the right to change any technical specifications/dimension and/or operating characteristics of the products at any time and without giving notice.

Filo

lavabo sottopiano con piano e mobile 90 maniglia orizzontale/verticale - lavabo a destra

Undercounter washbasin with countertop and cabinet 90, horizontal/vertical handle - washbasin on the right side

cielo
handmade in Italy

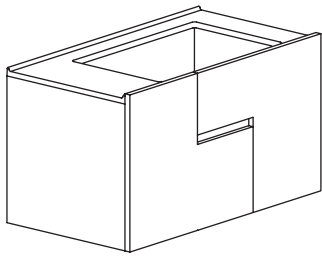

lavabo / washbasin
art. FILASPR58

top / countertop
art. FIP90DX / FIP90MDX

mobile maniglia orizzontale
/ horizontal handle cabinet
art. FIC90LO / FIC90EO

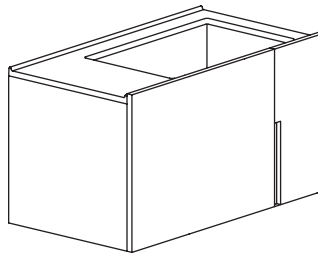

lavabo / washbasin
art. FILASPR58

top / countertop
art. FIP90DX / FIP90MDX

mobile maniglia verticale
/ vertical handle cabinet
art. FIC90LV / FIC90EV

NOTE/NOTES

Disponibile nell'opzione senza foro rubinetto (piano art. FIP90DXSF / FIP90MDXSF)
Available the option without tap hole (countertop art. FIP90DXSF / FIP90MDXSF)

Settembre 2024

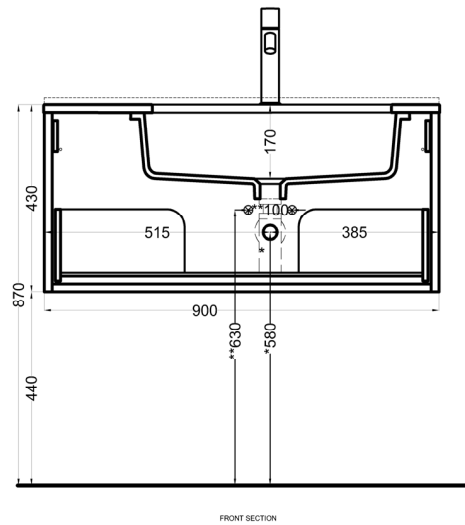
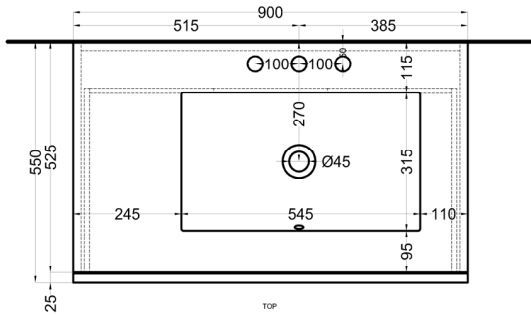

FRONT SECTION

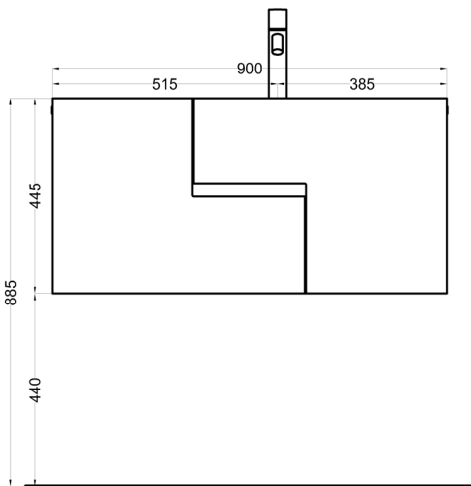

FRONT 1

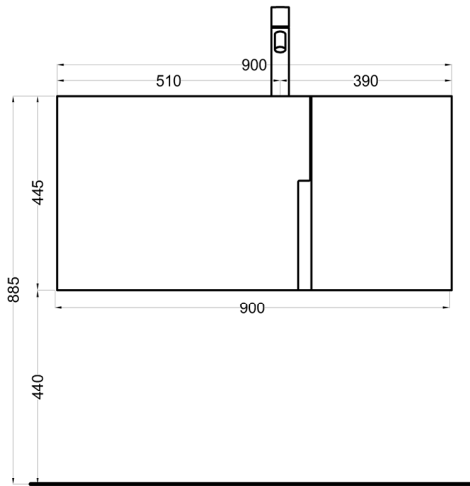

FRONT 2

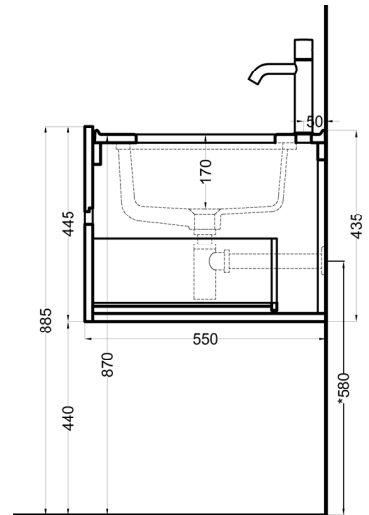

SIDE SECTION

* = water outlet (with standard siphon)

** = water inlet (hot/cold)

° = fixings

ATTENZIONE:

Superfici, pesi e misure riportate possono presentare leggere differenze rispetto ai pezzi reali, in considerazione e accordo delle caratteristiche di tolleranza intrinseche del materiale ceramico e del suo processo produttivo. L'azienda si riserva di cambiare schede tecniche e caratteristiche di funzionamento degli articoli in ogni momento e senza necessità di preavviso.

ATTENTION:

Surfaces, weights and dimensions can show some little differences compared to the real item, following typical intrinsic characteristics of ceramics material and production. The company reserves the right to change any technical specifications/dimension and/or operating characteristics of the products at any time and without giving notice.

Filo

piano e mobile 90 maniglia orizzontale/verticale - senza lavabo

countertop and cabinet 90, horizontal/vertical handle - no washbasin

cielo
handmade in Italy

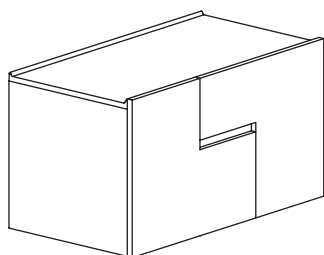

top / countertop
art. FIP90 / FIP90M

mobile maniglia orizzontale
/ horizontal handle cabinet
art. FIC90LOSF / FIC90EOSF

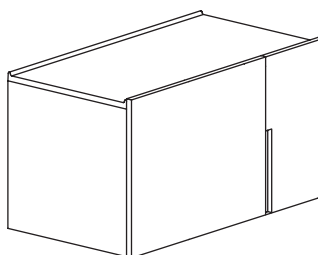

top / countertop
art. FIP90 / FIP90M

mobile maniglia verticale
/ vertical handle cabinet
art. FIC90LVSF / FIC90EVSF

Settembre 2024

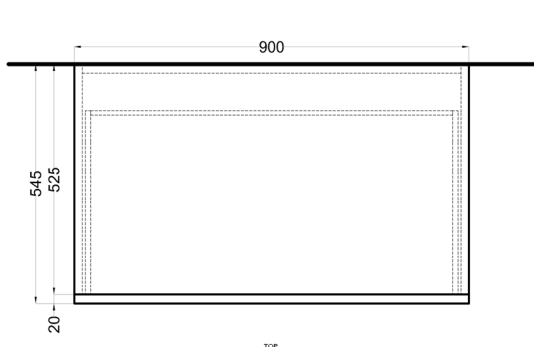

TOP

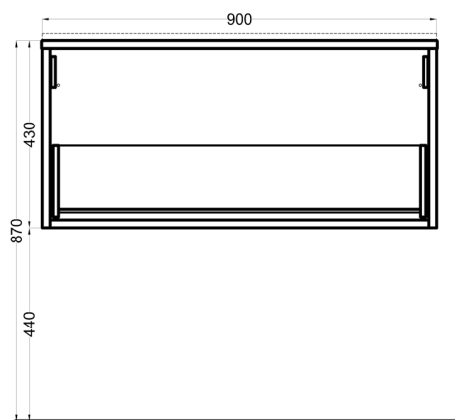

FRONT SECTION

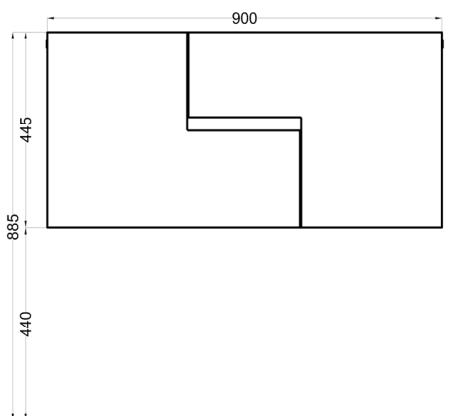

FRONT 1

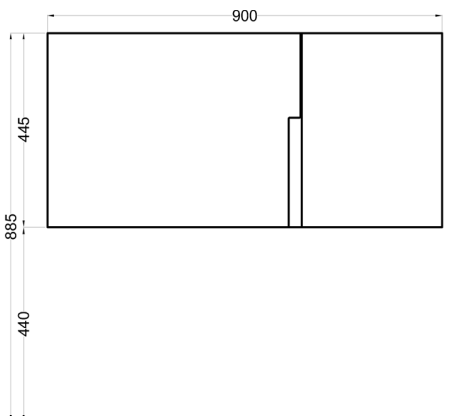

FRONT 1

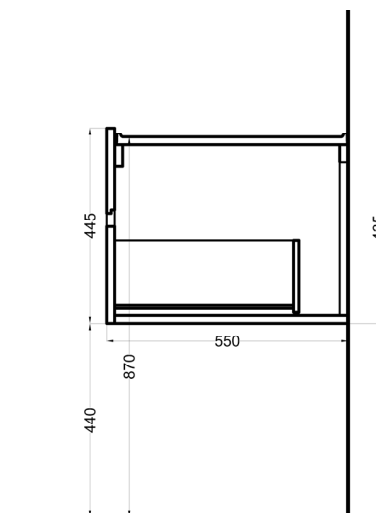

SIDE SECTION

* = water outlet (with standard siphon)

** = water inlet (hot/cold)

° = fixings

ATTENZIONE:

Superfici, pesi e misure riportate possono presentare leggere differenze rispetto ai pezzi reali, in considerazione e accordo delle caratteristiche di tolleranza intrinseche del materiale ceramico e del suo processo produttivo. L'azienda si riserva di cambiare schede tecniche e caratteristiche di funzionamento degli articoli in ogni momento e senza necessità di preavviso.

ATTENTION:

Surfaces, weights and dimensions can show some little differences compared to the real item, following typical intrinsic characteristics of ceramics material and production. The company reserves the right to change any technical specifications/dimension and/or operating characteristics of the products at any time and without giving notice.